

CHAINAGE (m)	3036.6	3000	2900	2800	2700	2600	2500	
ROCK COVER(m)			20	<40	<60		<80	
NGI Q(ROCK) VALUES(MEAN)		0.27-2.67 (0.94)	0.78-14.67 (5.51)	0.08-4.17 (1.37)	0.77-6.25 (2.31)	1.30-12.00 (3.45)	3.92-16.67 (8.05)	1.39-4.17 (3.03)
PERMEABILITY, OBTAINED FROM IN-SITU WATER ABSORPTION TESTS, K(MEAN) (x10 ⁻⁷ m/s)		4.14	59.70	2.18	5.38	9.00	1.05	6.33

P1	NOV 08	MING	FIRST ISSUE	FY	AFK
Rev	Date	Drawn	Description	Chk'd	App'd

THE GOVERNMENT OF THE HONG KONG
SPECIAL ADMINISTRATIVE REGION
WATER SUPPLIES DEPARTMENT

Mott MacDonald
Mott MacDonald Hong Kong Ltd.
7th Floor
West Wing Office Building
New World Centre
20 Salisbury Road
Tsim Sha Tsui, Kowloon
Hong Kong
Tel 2828 5757
Fax 2827 1823
Web www.mottmac.com.hk

Project
Agreement No. CE55/2006(EP)
Inter-reservoirs Transfer Scheme (IRTS)
Water Tunnel between Kowloon Byewash Reservoir and Lower Shing Mun Reservoir
Environmental Impact Assessment Investigation

Title
LONGITUDINAL GEOLOGICAL PROFILE FOR PROPOSED WATER TRANSFER TUNNEL
(SHEET 1 OF 5)

Designed	BV	Eng.Chk	FY
Drawn	MING	Coordination	FY
Dwg.Chk	FY	Approved	AFK
Scale	1:2000@A3	Project	240564
		CAD File	
Drawing No.	FIGURE 5-3a	Status	INF
		Rev	P1

(GEOLOGICAL MAP SHEET 7)
FINE-GRAINED GRANITE

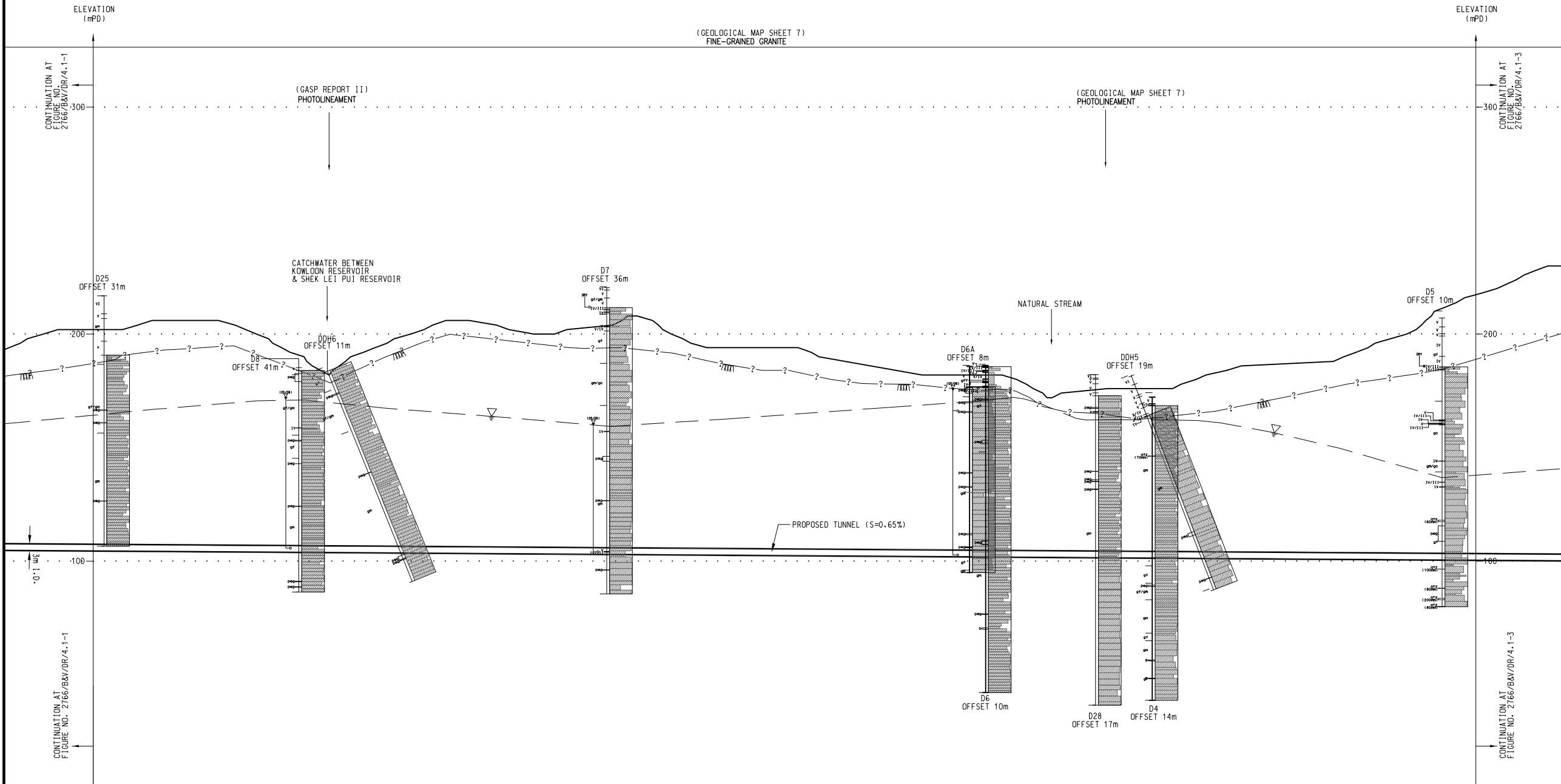

CHAINAGE (m)	2400	2300	2200	2100	2000	1900	1800
ROCK COVER(m)	<100	<80	<100	<80	<60	<80	<100
NGI Q(ROCK) VALVUS(MEAN)	1.39-4.17 (3.03)	1.95-3.67 (3.03)	3.12-5.50 (4.58)	2.53-16.67 (9.44)	2.39-4.17 (3.61) 6.42-16.67 (11.53)	2.53-4.17 (3.71) 3.33-16.67 (5.50)	1.21-4.17 (2.81) 0.09-6.35 (3.68)
PERMEABILITY, OBTAINED FROM IN-SITU WATER ABSORPTION TESTS, K(MEAN) (x10 ⁻⁷ m/s)	6.33	0.13	2.63	1.64	0.41 3.62	0.63 0.07	1.40 11.70

P1	NOV 08	MING	FIRST ISSUE	FY	AFK
Rev	Date	Drawn	Description	Chk'd	App'd

Client

 THE GOVERNMENT OF THE HONG KONG
 SPECIAL ADMINISTRATIVE REGION
 WATER SUPPLIES DEPARTMENT

Mott MacDonald
 Mott MacDonald Hong Kong Ltd.
 7th Floor
 West Wing Office Building
 New World Centre
 20 Salisbury Road
 Tsim Sha Tsui, Kowloon
 Hong Kong
 Tel 2828 5757
 Fax 2827 1823
 Web www.mottmac.com.hk

Project
 Agreement No. CE55/2006(EP)
 Inter-reservoirs Transfer Scheme (IRTS)
 Water Tunnel between Kowloon Byewash
 Reservoir and Lower Shing Mun Reservoir
 Environmental Impact Assessment
 Investigation

Title
 LONGITUDINAL GEOLOGICAL PROFILE FOR
 PROPOSED WATER TRANSFER TUNNEL
 (SHEET 2 OF 5)

Designed	BV	Eng.Chk	FY
Drawn	MING	Coordination	FY
Dwg.Chk	FY	Approved	AFK
Scale	1:2000@A3	Project	240564
		CAD File	
Drawing No.	FIGURE 5-3b		Rev
			P1

© Mott MacDonald Hong Kong Limited

This document should not be relied on or used in circumstances other than those for which it was originally prepared and for which Mott MacDonald Hong Kong Limited was commissioned. Mott MacDonald Hong Kong Limited accepts no responsibility for this document to any other party other than the person by whom it was commissioned.

C COPYRIGHT RESERVED

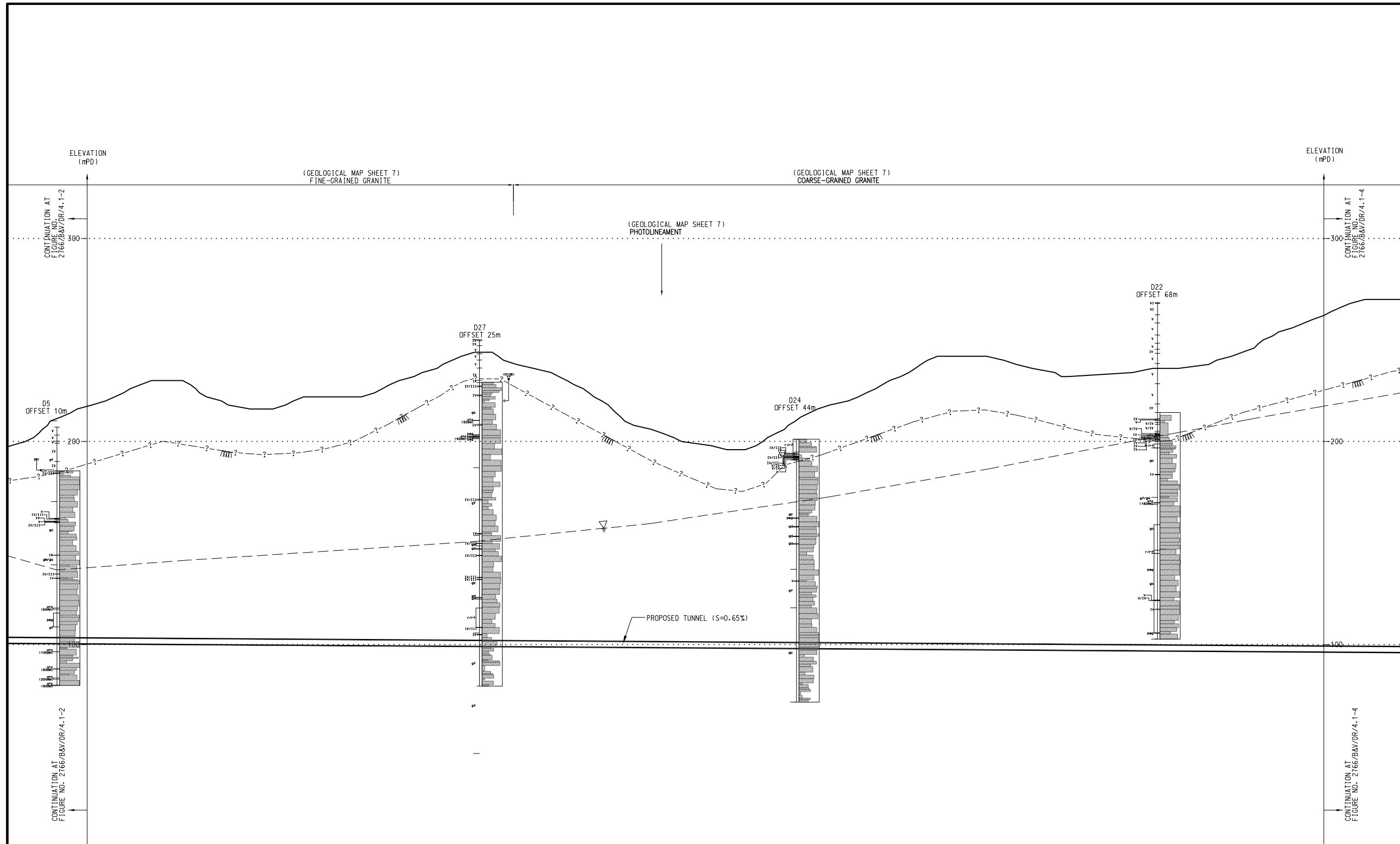

CHAINAGE (m)	1800	1700	1600	1500	1400	1300	1200
ROCK COVER(m)	<100	<120	<140	<120	<100	<80	<100
NGI Q(ROCK) VALUES(MEAN)			0.46-4.68 (2.51)				2.17-12.38 (5.76)
PERMEABILITY, OBTAINED FROM IN-SITU WATER ABSORPTION TESTS, K(MEAN) (x10 ⁻⁷ m/s)			9.45				5.95
						2.90	

P1	NOV 08	MING	FIRST ISSUE	FY	AFK
Rev	Date	Drawn	Description	Chk'd	App'd

Client

 THE GOVERNMENT OF THE HONG KONG
 SPECIAL ADMINISTRATIVE REGION
 WATER SUPPLIES DEPARTMENT

Mott MacDonald
 Mott MacDonald Hong Kong Ltd.
 7th Floor
 West Wing Office Building
 New World Centre
 20 Salisbury Road
 Tsim Sha Tsui, Kowloon
 Hong Kong
 Tel: 2828 5757
 Fax: 2827 1823
 Web: www.mottmac.com.hk

Project
 Agreement No. CE55/2006(EP)
 Inter-reservoirs Transfer Scheme (IRTS)
 Water Tunnel between Kowloon Byewash
 Reservoir and Lower Shing Mun Reservoir
 Environmental Impact Assessment
 Investigation

Title
 LONGITUDINAL GEOLOGICAL PROFILE FOR
 PROPOSED WATER TRANSFER TUNNEL
 (SHEET 3 OF 5)

Designed	BV	Eng. Chk.	FY
Drawn	MING	Coordination	FY
Dwg. Chk.	FY	Approved	AFK
Scale	1:2000@A3	Project	240564
		CAD File	
Drawing No.	FIGURE 5-3c		Rev
			P1

© Mott MacDonald Hong Kong Limited

This document should not be relied on or used in circumstances other than those for which it was originally prepared and for which Mott MacDonald Hong Kong Limited was commissioned. Mott MacDonald Hong Kong Limited accepts no responsibility for this document to any other party other than the person by whom it was commissioned.

C COPYRIGHT RESERVED

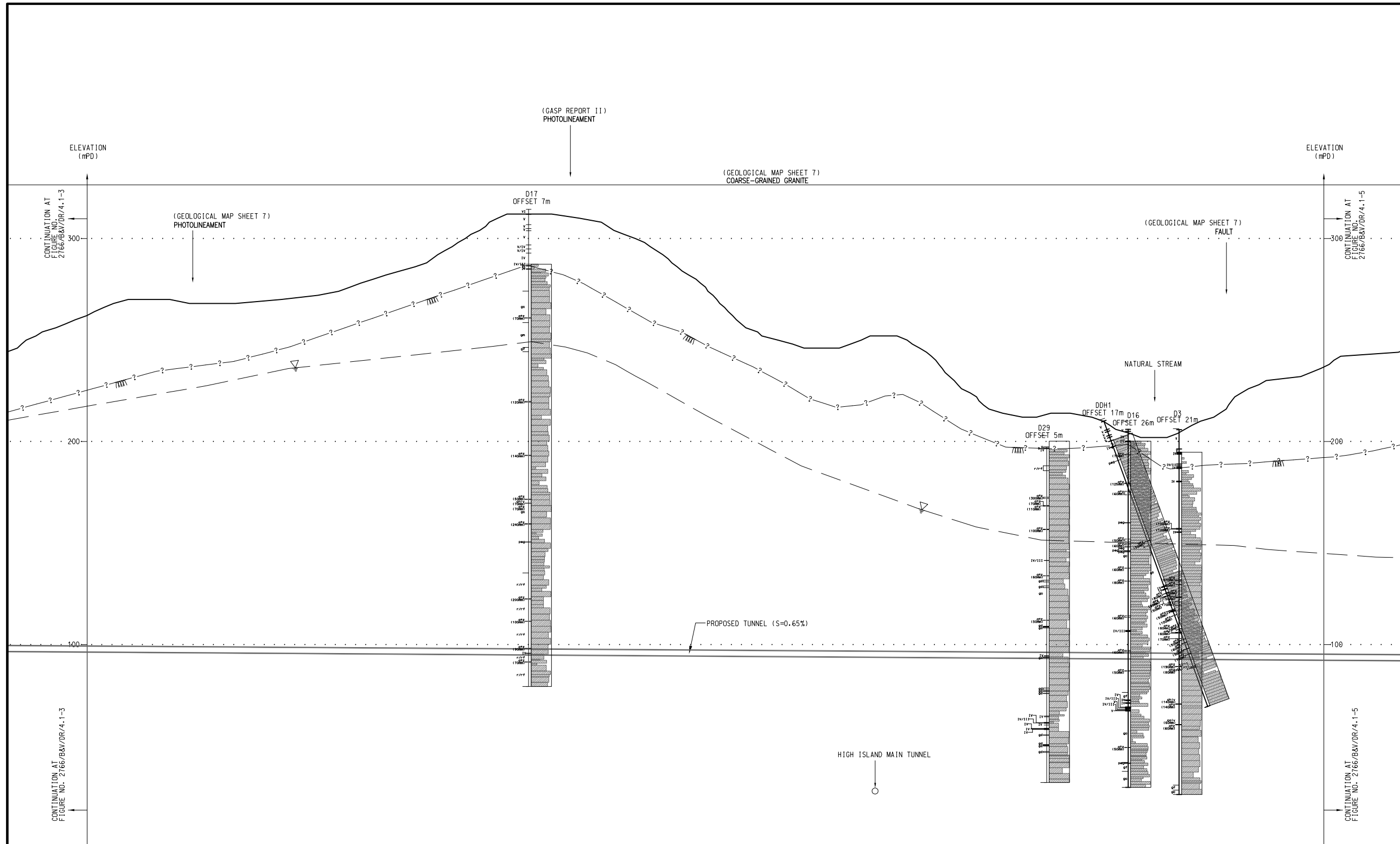

CHAINAGE (m)	1200	1100	1000	900	800	700	600							
ROCK COVER(m)	<140	<160	<180	<200	<220	<200	<180	<160	<140	<120	0.61-2.75 (1.61)	0.55-3.92 (1.67)	2.60-4.13 (3.81)	
NGI Q(ROCK) VALUES(MEAN)					1.75-12.13 (7.83)						1.84-4.13 (3.85)			
PERMEABILITY, OBTAINED FROM IN-SITU WATER ABSORPTION TESTS, K(MEAN) (x10 ⁻⁷ m/s)					7.41						3.77	2.41	3.62	2.50

P1	NOV 08	MING	FIRST ISSUE	FY	AFK
Rev	Date	Drawn	Description	Ch'kd	App'd

Client

 THE GOVERNMENT OF THE HONG KONG
 SPECIAL ADMINISTRATIVE REGION
 WATER SUPPLIES DEPARTMENT

Mott MacDonald
 Mott MacDonald Hong Kong Ltd.
 7th Floor
 West Wing Office Building
 New World Centre
 20 Salisbury Road
 Tsim Sha Tsui, Kowloon
 Hong Kong
 Tel: 2828 5757
 Fax: 2827 1823
 Web: www.mottmac.com.hk

Project
 Agreement No. CE55/2006(EP)
 Inter-reservoirs Transfer Scheme (IRTS)
 Water Tunnel between Kowloon Byewash
 Reservoir and Lower Shing Mun Reservoir
 Environmental Impact Assessment
 Investigation

Title
 LONGITUDINAL GEOLOGICAL PROFILE FOR
 PROPOSED WATER TRANSFER TUNNEL
 (SHEET 4 OF 5)

Designed	BV	Eng.Chk	FY
Drawn	MING	Coordination	FY
Dwg.Chk	FY	Approved	AFK
Scale	1:2000@A3	Project	240564
		CAD File	
Drawing No.	FIGURE 5-3d		Rev
			P1

© Mott MacDonald Hong Kong Limited

This document should not be relied on or used in circumstances other than those for which it was originally prepared and for which Mott MacDonald Hong Kong Limited was commissioned. Mott MacDonald Hong Kong Limited accepts no responsibility for this document to any other party other than the person by whom it was commissioned.

C COPYRIGHT RESERVED

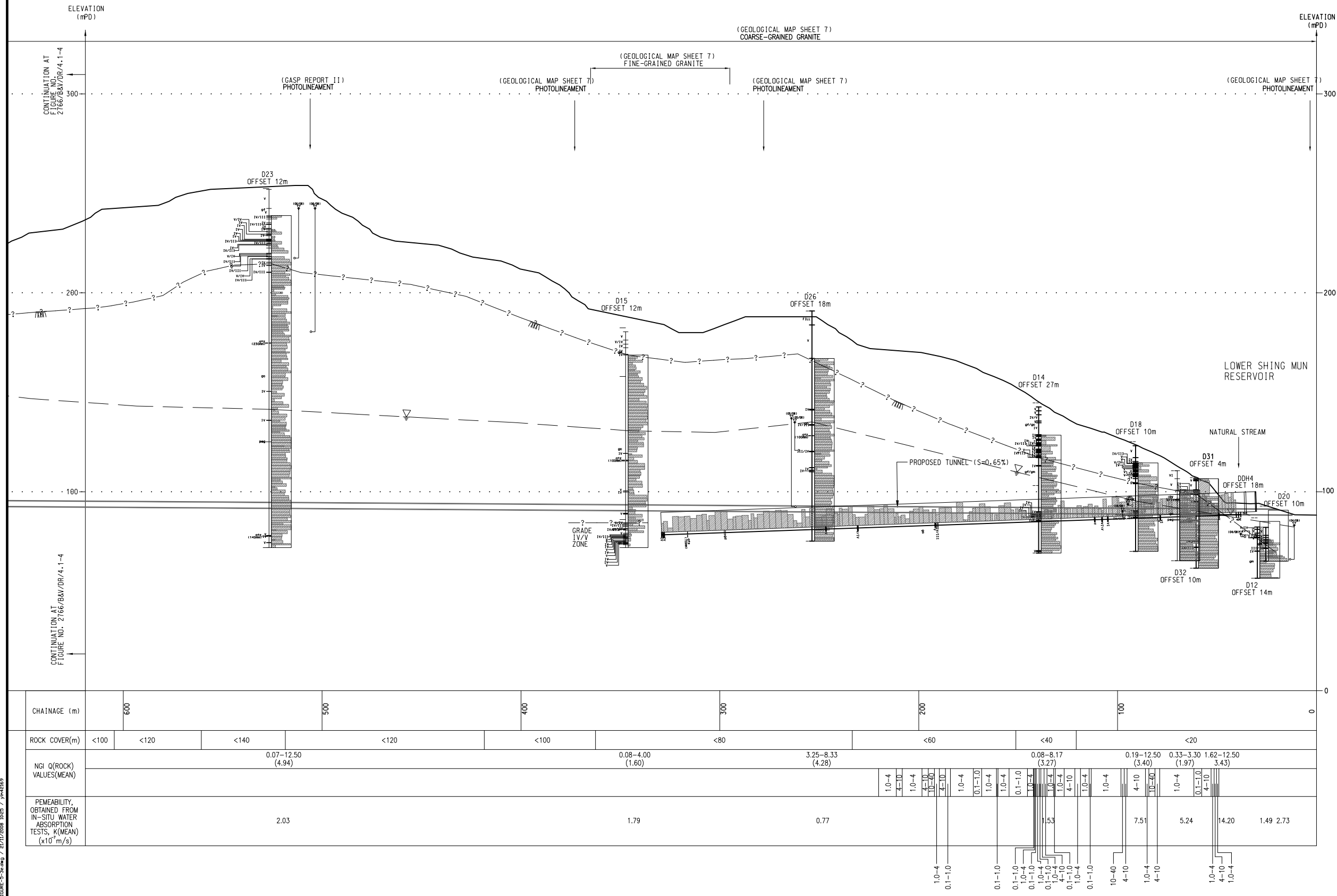

CHAINAGE (m)	600	500	400	300	200	100	0						
ROCK COVER(m)	<100	<120	<140	<120	<100	<80	<60	<40	<20				
NGI Q(ROCK) VALUES(MEAN)	0.07-12.50 (4.94)		0.08-4.00 (1.60)		3.25-8.33 (4.28)		0.08-8.17 (3.27)		0.19-12.50 (3.40)	0.33-3.30 (1.97)	1.62-12.50 (3.43)		
PERMEABILITY, OBTAINED FROM IN-SITU WATER ABSORPTION TESTS, K(MEAN) (x10 ⁻⁸ m/s)	2.03		1.79		0.77		1.53		7.51	5.24	14.20	1.49	2.73

© Mott MacDonald Hong Kong Limited
 This document should not be relied on or used in circumstances other than those for which it was originally prepared and for which Mott MacDonald Hong Kong Limited was commissioned. Mott MacDonald Hong Kong Limited accepts no responsibility for this document to any other party other than the person by whom it was commissioned.

C COPYRIGHT RESERVED

P1	NOV 08	MING	FIRST ISSUE	FY	AFK
Rev	Date	Drawn	Description	Chk'd	App'd

Client
THE GOVERNMENT OF THE HONG KONG SPECIAL ADMINISTRATIVE REGION
 WATER SUPPLIES DEPARTMENT

Mott MacDonald
 Mott MacDonald Hong Kong Ltd.
 7th Floor
 West Wing Office Building
 New World Centre
 20 Salisbury Road
 Tsim Sha Tsui, Kowloon
 Hong Kong
 Tel 2828 5757
 Fax 2827 1823
 Web www.mottmac.com.hk

Project
 Agreement No. CE55/2006(EP)
 Inter-reservoirs Transfer Scheme (IRTS)
 Water Tunnel between Kowloon Byewash Reservoir and Lower Shing Mun Reservoir
 Environmental Impact Assessment Investigation

Title
LONGITUDINAL GEOLOGICAL PROFILE FOR PROPOSED WATER TRANSFER TUNNEL
 (SHEET 5 OF 5)

Designed	BV	Eng.Chk	FY
Drawn	MING	Coordination	FY
Dwg.Chk	FY	Approved	AFK
Scale	1:2000@A3	Project	240564
		CAD File	
Drawing No.	FIGURE 5-3e		Rev
			P1